

# 2025

## Regenerative Medicine Essentials Course

June 10-12 | Winston-Salem, North Carolina

**WFIRM**

Wake Forest Institute for  
Regenerative Medicine



REGENERATIVE  
MEDICINE  
FOUNDATION

**\*NEW\***

FREE  
Public Day  
June 9

# 12th Annual Regenerative Medicine Essentials: From Fundamentals to the Future

## Sponsorship Prospectus

*Live & Virtual Sponsorship Formats*

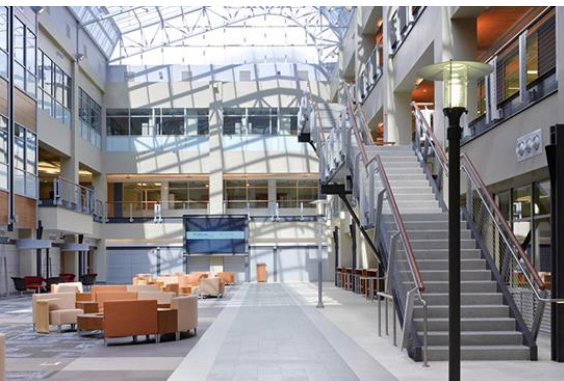

# Invitation to Sponsors

The Wake Forest Institute for Regenerative Medicine (WFIRM) and the Regenerative Medicine Foundation (RMF) have announced the 12th annual Regenerative Medicine Essentials (RME). This in-person event also offers virtual attendance options, offering attendees from across the globe a highly interactive experience.

This 3-day course invites all students, as well as clinical and industry practitioners and regulators interested in the field of regenerative medicine, whether their interests and career goals are in the basic sciences, clinical epidemiology, bioethics, biomanufacturing, or other areas. From the science behind pioneering discoveries and clinical applications, to regulatory and manufacturing challenges, the 3-day course provides a comprehensive look at progress to date, current challenges, new “hot” topics, future applications and today's priorities.

The annual event includes research, clinical, industry, manufacturing, government, educational, patient advocates and student representatives interested in the field of regenerative medicine, whether their interests and career goals are in the basic sciences, clinical applications, regulator, biomanufacturing and bio-business, convergent technologies or other areas. In addition to individual lectures and engaging panel discussions with prominent leaders from around the world, participants have additional opportunities to gain an enhanced foundation in this promising field through special networking, demos and other partnering opportunities.

As a distinguished sponsor, you will have the unique opportunity to connect with more > 50 prominent instructors, and RME participants who are leaders in the field and overall event participants. Attendees are a distinguished group of scientists, engineers, clinicians from academic, government and industry sectors who join us from across the region, U.S. and globe. Additionally, as an included benefit, we invite sponsors/exhibitors to join all course sessions as well as participate in the new Public Day component, held June 9th, engaging extended groups across our region.

Sincerely,  
Anthony Atala, MD  
WFIRM, RME  
Course Director

Joan F. Schanck, MPA  
WFIRM, RME  
Course Co-Director

## Course Topics:

- ▶ Stem Cells
- ▶ Biomaterials
- ▶ 3D Printing and Enabling Technologies
- ▶ Cell Therapies
- ▶ Tissue Engineering
- ▶ Regulatory, Process Development
- ▶ Scale-up and Manufacturing
- ▶ Clinical Trials
- ▶ Commercialization
- ▶ Bioethics and Patient Advocacy
- ▶ Career Perspectives and Workforce Development
- ▶ New & Advanced topics, e.g., Advancement of Sensor Integrated Organ-on-Chip Devices, Stem Cells and the International Space Station, A World Compass for Manufacturing and Marketing Cell and Gene Therapies

## Designed For:

- ▶ Researchers
- ▶ Clinicians
- ▶ MD, PhD, MS students
- ▶ Government
- ▶ Industry
- ▶ Technicians
- ▶ Investors & Collaborators
- ▶ Advanced Students and Educators
- ▶ Patient Advocates



# Sponsorship Opportunities

Our team would love to find out more about your goals and ambitions and how best to support you at RME 2025. The RME 2025 will be held at the Wake Forest Bowman Gray Medical Education Center. There are a range of opportunities to get yourselves noticed! We invite corporations, foundations and other organizations to consider sponsorship where we expect to connect more than 500 stakeholders and leaders in the field from across the globe in both live and virtual formats. Sponsorship opportunities and various attractive benefits are listed below and will be featured on the WFIRM, RMF, RegMIC, and ReMDO websites. We look to further customize your sponsorship to your specific interests.

## Platinum Partner Sponsors \$5,000

*LIMITED SLOTS (2)*

- Workshop and/or demos (various virtual and live formats and lengths)
- Full page ad in the digital program and the mobile event app
- Large logo on all digital materials
- Large logo on sponsorship banner during event breaks
- Large logo with sponsor links on WFIRM RME Course, RMF, RegMIC and ReMDO websites (runs for one year)
- Exhibit space
- 3 full registrations

## Gold Sponsors \$3,500

*LIMITED SLOTS (3)*

- Recorded/Virtual short infomercials, demos
- Half page ad in the digital program and the mobile event app
- Large logo on all digital materials
- Large logo with sponsor links on WFIRM RME Course, RMF, RegMIC, and ReMDO websites (runs for one year)
- Exhibit space
- 2 full registrations

**Exhibitors** \$550/day or \$1,500.00/3-days with full registration to Public Day Expo and 3-day course

- Small logo on program and signate and website
- Exhibit space

## Silver Sponsors \$1,750

- Medium logo on all digital materials
- Medium logo with sponsor links on WFIRM RME Course, RMF, RegMIC, and ReMDO websites (runs for one year)
- Quarter page ad in the digital program and the mobile event app
- Exhibit space
- 1 full registration

## Young Scientist Award Sponsor \$1,000

- Sponsor course scholarships for students
- Medium logo on all digital materials
- Medium logo with sponsor links on WFIRM RME Course, RMF, RegMIC, and ReMDO websites (runs for one year)
- 4 student registrations

## Advertisement Sponsor \$750

- Quarter page ad in the digital program and mobile event app
- Small logo on all digital materials
- Small logo with sponsor links on WFIRM RME Course, RMF, RegMIC, and ReMDO websites (runs for one year)
- 1 full registration

## General Sponsor \$500

- Small logo on digital materials
- Small logo with sponsor links on WFIRM RME Course and RMF websites (runs for one year)

**Sponsorship contact:** Joan Schanck 412/889-7865 or [jschanck@wakehealth.edu](mailto:jschanck@wakehealth.edu)

For more information about the RME Course and RMF, visit [wakehealth.edu/RMEssentials](http://wakehealth.edu/RMEssentials)